

Data sheet EN U032 INTEGRA-pw 2.5 to 3.5-1143 / pre-assembly, bulge inside

INTEGRA-pw safety barrier

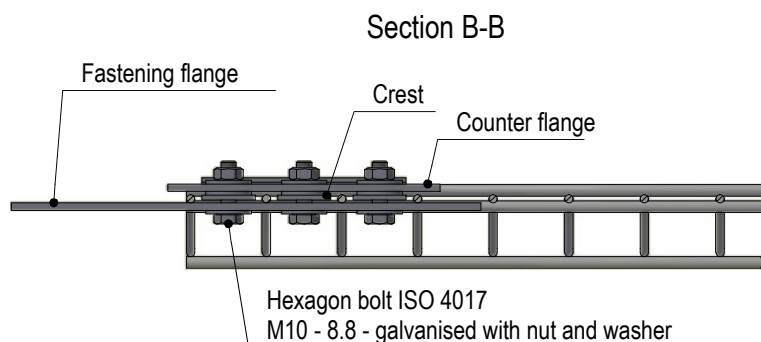
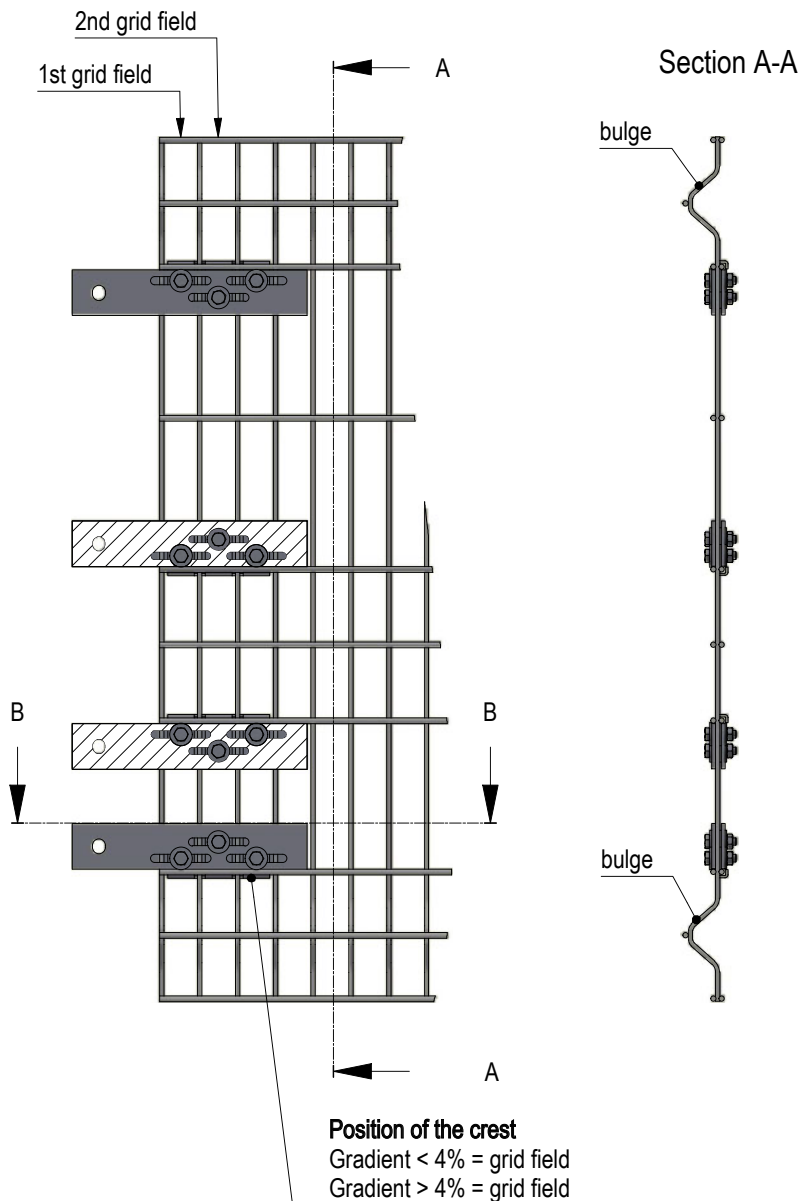

Note:

For the final assembly, the pre-assembled bolts must be loosened. The mat is to be centred between the connecting components. The final assembly and fastening of the bolting is carried out according to the data sheet U012 or U014.

The crest is mounted starting with the first grid field for straight mat designs and starting with the second grid field for ramp designs with a gradient > 4%.

INTEGRA-pw 2.5 and INTEGRA-pw 3.0 with 2 fastenings per side.

INTEGRA-pw 3.5 with 4 fastenings per side.

Legends for packing list/delivery note:

hdg	Hot-dip galvanized
pa	Pre-assembled
fast.	Fastenings
B-out	Bulge outside
B-in	Bulge inside
cons.	consisting of