

Data sheet EN 320 - Woodline side panelling with 22-mm joint

Urban Systems

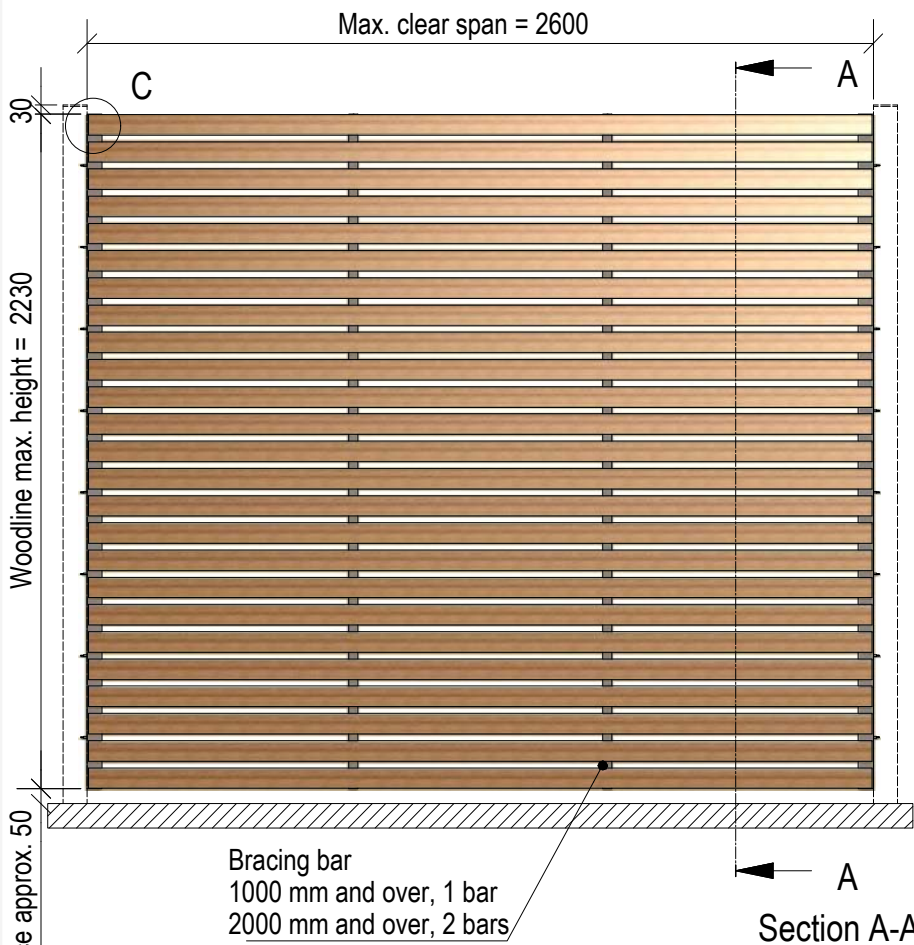

**Product description:**

untreated larch rhombus slat  
 68x20 mm, 15° chamfer, planed  
 and rounded

Slat spacing: 22 mm

Strip-galvanised steel angle bracket,  
 50x25 mm for mounting the wooden  
 elements and fastening to the  
 supports

Bracing bar made from strip-  
 galvanised flat bar, 30 mm

Max. element height: 2230 mm

Max. element width: 2600 mm

Elements are mounted between the  
 supports, front edge of the element  
 flush with the support

V2A screw

**Detail B**

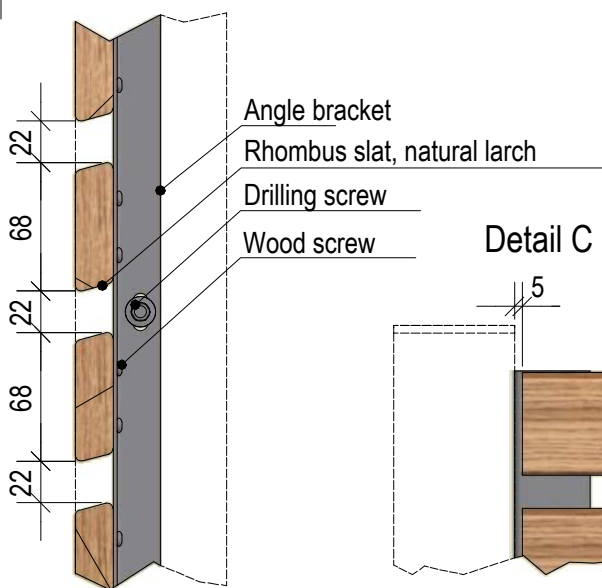

**Detail C**

